

FIT INSTRUCTIONS

CONVERT™ HARNESS

1. LOOSEN THE CHEST VELCRO STRAP
2. PLACE THE HARNESS ON THE DOG
3. ADJUST THE CHEST STRAP SO THAT THE HARNESS IS POSITIONED COMFORTABLY BEHIND THE DOG'S FRONT LEGS.
4. CLIP THE GIRTH STRAP TOGETHER AND ADJUST SO THAT IT FITS SNUG BUT NOT TOO TIGHT.

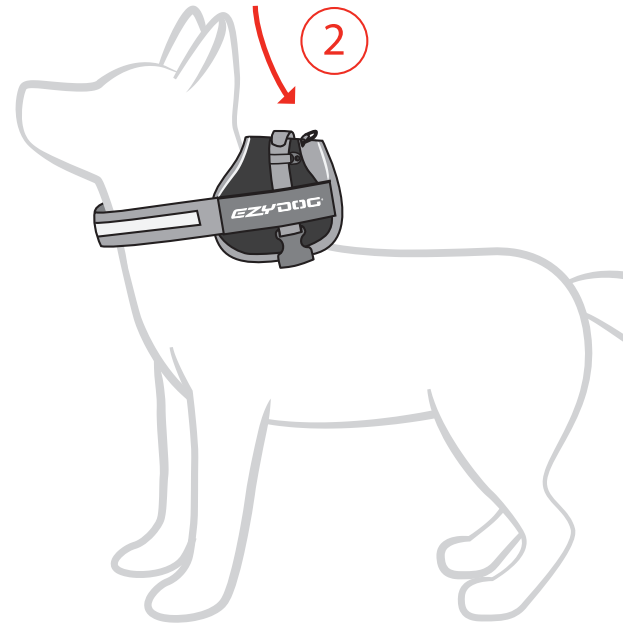

TIP: KEEP THE CHEST STRAP A LITTLE LOOSE SO THAT THE GIRTH STRAP DOES NOT PULL INTO YOUR DOG'S LEGS

IMPORTANT: DO NOT OVER-TIGHTEN STRAPS! WHEN FITTED CORRECTLY, HARNESS SHOULD BE SNUG, BUT TWO FINGERS SHOULD EASILY RUN BETWEEN STRAPS & DOG.

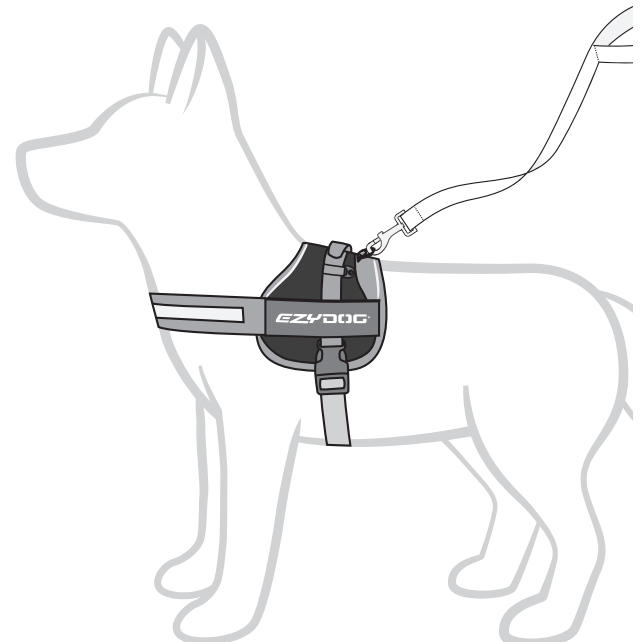

NOW GO AND PLAY!

for more information go to
www.ezydog.com